

Brass housing, adjustable

Operating pressure 0 to 15 bar
 Operating temperature -10 °C to 250 °C
 Pore size 50 µm

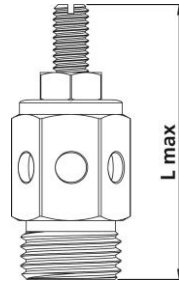
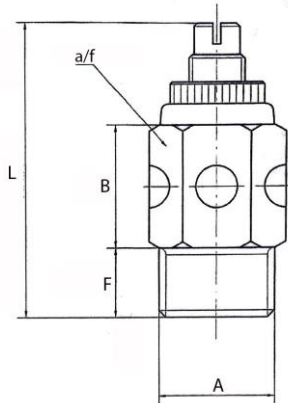

SD14MSEB

Silencer, sintered bronze. brass housing, adjustable

Art. No.	Type No.	Thread A	F mm	B mm	a/f mm	L mm	L max. mm
156513	SD18MSEB	G 1/8	6.5	13.0	13	29.0	32.5
156514	SD14MSEB	G 1/4	8.5	16.0	14	36.0	45.0
156515	SD38MSEB	G 3/8	10.0	17.5	17	42.0	47.5
156516	SD12MSEB	G 1/2	10.5	20.0	22	44.0	55.5
156517	SD34MSEB	G 3/4	13.5	24.0	27	55.0	67.0
156518	SD1MSEB	G 1	15.5	31.0	34	64.0	77.5

Flow rates and Noise levels

Art. No.	Type No.	Flow rate l/min.	Noise level, reduced
156513	SD18MSEB	320	≥ 23 dB(A)
156514	SD14MSEB	540	≥ 12 dB(A)
156515	SD38MSEB	680	≥ 14 dB(A)
156516	SD12MSEB	1335	≥ 8 dB(A)
156517	SD34MSEB	1740	≥ 10 dB(A)
156518	SD1MSEB	2150	≥ 7 dB(A)

- The use of silencers does not automatically reduce exhaust noise to a safe level.
The need for other noise-reducing measures, such as hearing protection, must be assessed as well.

- Uses and applications are the responsibility of the user. However, it is necessary to carry out appropriate tests before use in order to convince yourself of the desired function under the respective conditions.
All further claims, in particular liability for consequential damages, are excluded in principle.

Non-binding standard values, depending on the application and adaptation. The suitability test for the respective application is the responsibility of the user.